

### SRS RESIDENCY

1

Approved by the Government of Punjab, Lahore

20/03/2010

Approved by the Government of Punjab, Lahore

20/03/2010

### RAIN WATER HARVESTING DETAIL

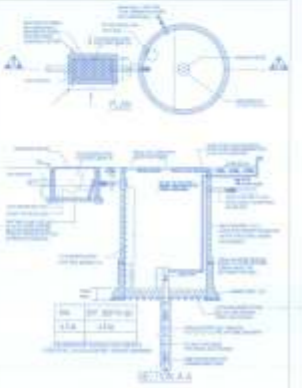

### LEGEND FOR PLANNING

- Symbol: Wheel for drainage
- Symbol: Solid line for drainage
- Symbol: Dashed line for cold water supply pipe
- Symbol: Dotted line for ground level
- Symbol: Dash-dot line for wet level
- Symbol: Long-dash line for connection level
- Symbol: Short-dash line for metre
- Symbol: Solid line for length
- Symbol: Solid line for sewer pipe
- Symbol: Solid line for check valve return scale

### ADDITION & ALTERATION IN SITE PLAN

PROPOSED & ADDITIONAL BUILDING PLAN FOR AREA 18.73+3.32 ACRES  
PROPOSED SRS RESIDENCY AT BASELWA SECTOR-87, FARIDABAD FOR M/S SRS REAL ESTATE LTD.  
LC NO. - 89 OF 2008 DT. - 25.03.2008 AND LC NO. - 46 DT. - 19.06.2010

M/S SRS REAL ESTATE LTD, AT SRS MULTIPLEX, SECTOR-12, FARIDABAD, HARYANA.

GAUTAM & GAUTAM ASSOCIATES ARCHITECTS, INTERIOR DESIGNERS & VALUERS  
PLOT NO- 112, SECTOR-19, FARIDABAD.  
PHONE: 0171-4348461, 4348462, FAX: 0171-4348463  
E-MAIL: gautamgautam@gmail.com

Scale: 1:1000

North Arrow

1

FLOOR	TYPE I (2 BDR)	TYPE II (3 BDR)	TYPE III (4 BDR)	TYPE IV (5 BDR)	TYPE V (6 BDR)	TYPE VI (7 BDR)	TYPE VII (8 BDR)	TOTAL
FLOOR	1	2	3	4	5	6	7	1
NO. OF UNITS	100	200	100	50	20	10	5	485
TOTAL	100	200	100	50	20	10	5	485

FLOOR	TYPE I (2 BDR)	TYPE II (3 BDR)	TYPE III (4 BDR)	TYPE IV (5 BDR)	TYPE V (6 BDR)	TYPE VI (7 BDR)	TYPE VII (8 BDR)	TOTAL
NO. OF UNITS	100	200	100	50	20	10	5	485
AREA (SQ.M)	1000	2000	1000	500	200	100	50	4350
TOTAL	1000	2000	1000	500	200	100	50	4350

AREA	TYPE I (2 BDR)	TYPE II (3 BDR)	TYPE III (4 BDR)	TYPE IV (5 BDR)	TYPE V (6 BDR)	TYPE VI (7 BDR)	TYPE VII (8 BDR)	TOTAL
AREA (SQ.M)	1000	2000	1000	500	200	100	50	4350
TOTAL	1000	2000	1000	500	200	100	50	4350

AREA	TYPE I (2 BDR)	TYPE II (3 BDR)	TYPE III (4 BDR)	TYPE IV (5 BDR)	TYPE V (6 BDR)	TYPE VI (7 BDR)	TYPE VII (8 BDR)	TOTAL
NO. OF UNITS	100	200	100	50	20	10	5	485
AREA (SQ.M)	1000	2000	1000	500	200	100	50	4350
TOTAL	1000	2000	1000	500	200	100	50	4350

AREA DETAIL FOR LANDSCAPE GREEN PARK

MINIMUM GREEN AREA REQUIRED IS 10% OF TOTAL AREA  
TOTAL GREEN AREA PROVIDED IS 20% OF TOTAL AREA

MINIMUM GREEN AREA PROVIDED = 20% OF TOTAL AREA  
TOTAL GREEN AREA PROVIDED = 20% OF TOTAL AREA

PARKING CALCULATION

MINIMUM NO. OF CARS REQUIRED IS 1.5 PER DWELLING UNIT  
TOTAL NO. OF CARS REQUIRED IS 727.5  
TOTAL NO. OF CARS PROVIDED IS 727.5

PARKING UNDER STILT AND PODIUM

AREA OF STILT & PODIUM = 10000 SQ.M  
NO. OF CARS PROVIDED UNDER STILT AND PODIUM = 1000

STILT UNDER BLOCK D=700.00 SQ.M  
TOTAL AREA = 10000.00 SQ.M  
NO. OF CARS PROVIDED UNDER STILT AND PODIUM = 1000

NO. OF CARS PROVIDED IN OPEN SURFACE AREA = 455 CARS  
TOTAL NO. OF CARS PROVIDED = 1455 CARS



AREA UNDER FOR SCHOOL SITE  
AREA UNDER FOR NURSERY SITE  
AREA UNDER FOR PLAYGROUND  
AREA UNDER FOR GYM  
AREA UNDER FOR CLUB HOUSE  
AREA UNDER FOR SHOPPING CENTRE  
AREA UNDER FOR PARKING

NO. APPROVED & SALES

TOTAL SITE AREA 14.12 ACRES  
TOTAL BUILT UP AREA 141200 SQ.M

PROPOSED AREA CALCULATION (PROPOSED FLOOR):  
PROPOSED 1ST FLOOR AREA OF TYPE I ON TYPICAL FLOOR = 1000 SQ.M  
PROPOSED 2ND FLOOR AREA OF TYPE II ON TYPICAL FLOOR = 2000 SQ.M  
PROPOSED 3RD FLOOR AREA OF TYPE III ON TYPICAL FLOOR = 1000 SQ.M  
PROPOSED 4TH FLOOR AREA OF TYPE IV ON TYPICAL FLOOR = 500 SQ.M  
PROPOSED 5TH FLOOR AREA OF TYPE V ON TYPICAL FLOOR = 200 SQ.M  
PROPOSED 6TH FLOOR AREA OF TYPE VI ON TYPICAL FLOOR = 100 SQ.M  
PROPOSED 7TH FLOOR AREA OF TYPE VII ON TYPICAL FLOOR = 50 SQ.M

PROPOSED AREA CALCULATION (COMMON AREAS):  
STILT & PODIUM = 10000 SQ.M  
STILT UNDER BLOCK D = 700 SQ.M  
STILT UNDER BLOCK E = 700 SQ.M  
STILT UNDER BLOCK F = 700 SQ.M  
STILT UNDER BLOCK G = 700 SQ.M  
STILT UNDER BLOCK H = 700 SQ.M  
STILT UNDER BLOCK I = 700 SQ.M  
STILT UNDER BLOCK J = 700 SQ.M  
STILT UNDER BLOCK K = 700 SQ.M  
STILT UNDER BLOCK L = 700 SQ.M  
STILT UNDER BLOCK M = 700 SQ.M  
STILT UNDER BLOCK N = 700 SQ.M  
STILT UNDER BLOCK O = 700 SQ.M  
STILT UNDER BLOCK P = 700 SQ.M  
STILT UNDER BLOCK Q = 700 SQ.M  
STILT UNDER BLOCK R = 700 SQ.M  
STILT UNDER BLOCK S = 700 SQ.M  
STILT UNDER BLOCK T = 700 SQ.M  
STILT UNDER BLOCK U = 700 SQ.M  
STILT UNDER BLOCK V = 700 SQ.M  
STILT UNDER BLOCK W = 700 SQ.M  
STILT UNDER BLOCK X = 700 SQ.M  
STILT UNDER BLOCK Y = 700 SQ.M  
STILT UNDER BLOCK Z = 700 SQ.M

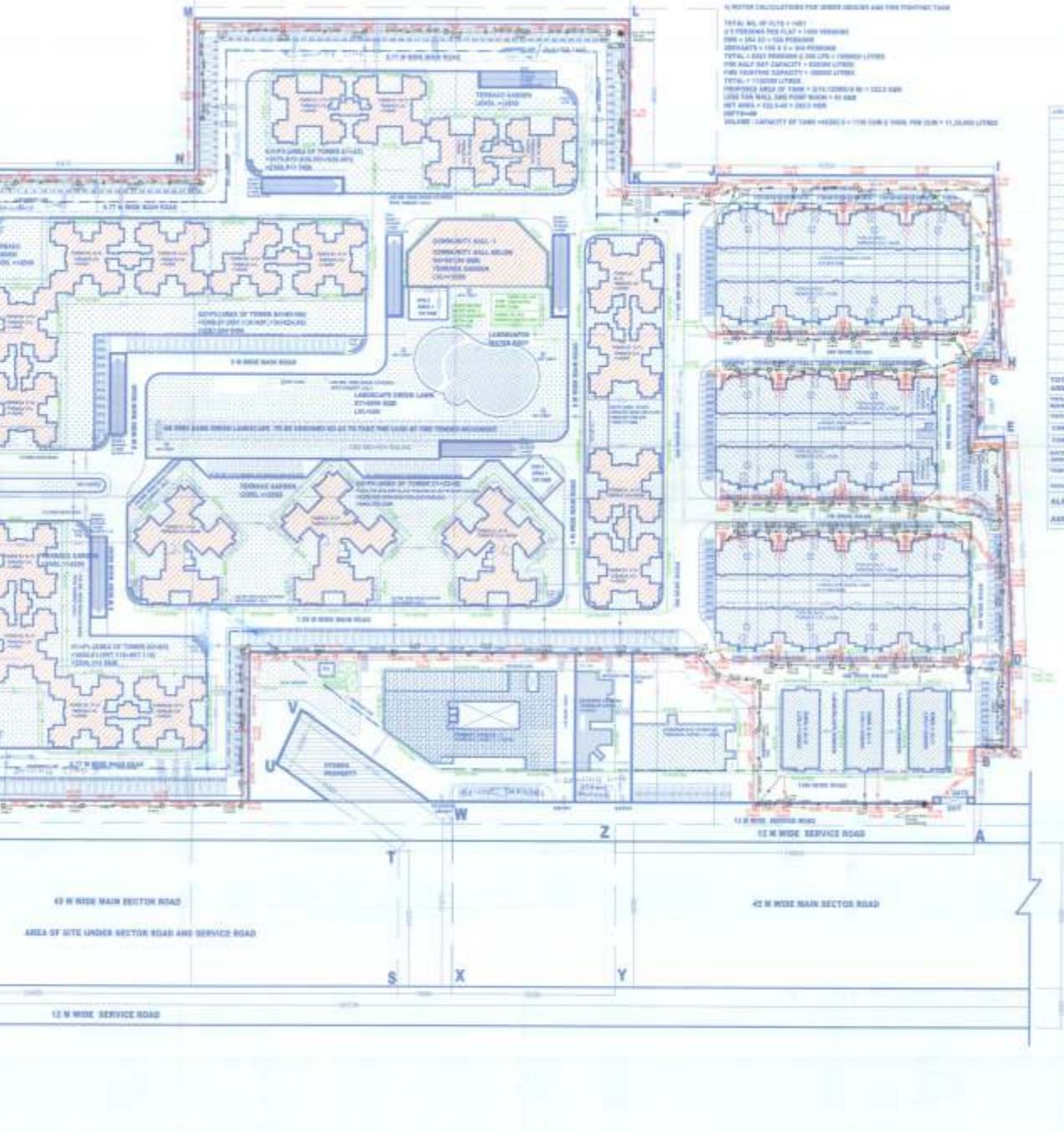

PROPOSED AREA CALCULATION (TOTAL):  
TOTAL BUILT UP AREA = 141200 SQ.M  
TOTAL COMMON AREA = 10000 SQ.M  
TOTAL SITE AREA = 14.12 ACRES

NO. OF CARS PROVIDED IN OPEN SURFACE AREA = 455 CARS  
TOTAL NO. OF CARS PROVIDED = 1455 CARS